

Lead Free

FULL PORT BALL VALVE W/DRAIN

- 600# WOG
- California AB1953 Lead Free Approved
- ANSI/NSF 61-8 Approved
- Blow Out Proof Stem
- Full Port
- Fed. Spec. WW-V-35, Type II, Class A Style 3
- MSS-SP-110
- ISO 9001 Manufacturer

No. Part	Materials Specification
① Nut	Forged Steel ASTM - AISI-1010
② Handle	Forged Steel ASTM-A-283-D
③ Packing Nut	Brass ASTM B-16, C36000
④ Packing	PTFE
⑤ Stem	Brass ASTM B-455, C28000
⑥ Body	Brass ASTM B-455, C28000
⑦ Seat Rings (2)	PTFE
⑧ Ball	Brass ASTM B-455, C28000
⑨ Body End Cap	Forged Brass ASTM B-124, C37700
⑩ Drain Packing	NBR
⑪ Drain Nut	Brass ASTM B-455, C28000

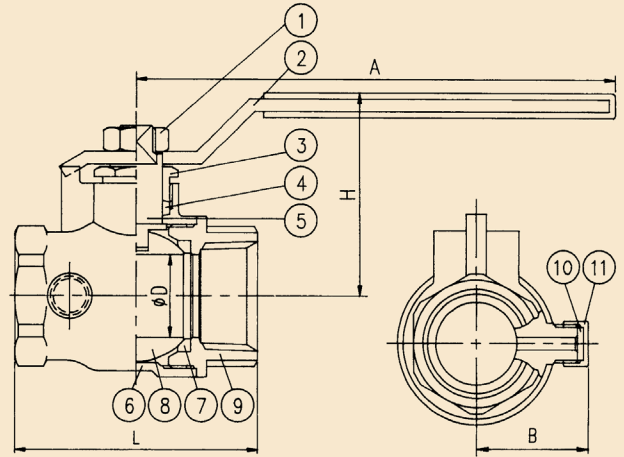

172 8175L SERIES								
BRASS BALL VALVE W/DRAIN, THREADED								
Size	Fig. #	Weight	Box/Case	L	H	D	A	B
1/2	172 8175 GL	0.50	10/120	2.01	1.54	0.50	3.31	0.91
3/4	172 8175 IL	0.92	10/60	2.36	1.97	0.79	4.65	1.10
1	172 8175 KL	1.41	6/36	2.87	2.13	0.98	4.65	1.26

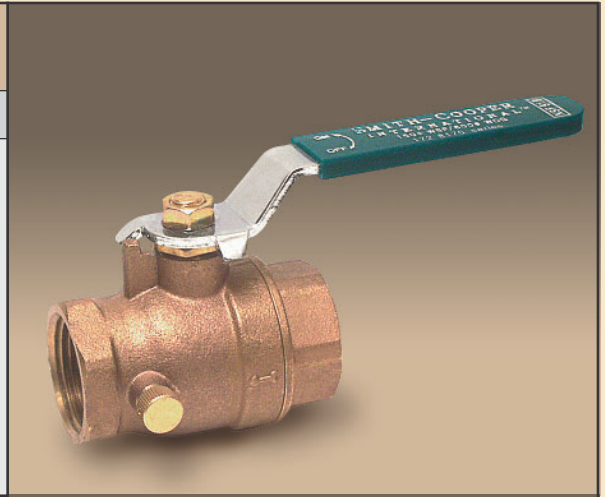

172 8176L SERIES								
BRASS BALL VALVE W/DRAIN, SOLDER END								
Size	Fig. #	Weight	Box/Case	L	H	D	A	B
1/2	172 8176 GL	0.50	10/120	1.93	1.54	0.50	3.31	0.91
3/4	172 8176 IL	0.92	10/60	2.76	1.97	0.79	4.65	1.10
1	172 8176 KL	1.41	6/36	3.30	2.13	0.98	4.65	1.26

