



**COOPLOK™ Grooved Submittal**

**Fig. 65SF & 66SF  
Standard Weight Flexible Coupling**

Figure 65SF & 66SF Standard Weight Flexible couplings are designed for use in piping systems where flexibility is desired. They allow for pipe movement caused by seismic action and thermal variations, and will also attenuate noise & vibration transmitted through the piping system.



**Material Specifications**

**Housing:**

Ductile Iron Housings conform to ASTM A-536, Grade 65-45-12

**Coating:**

- Orange Paint (Rust inhibiting) - Standard Coating – Fig 65SF
- Hot Dipped Galvanized conforming to ASTM A-153 – Fig 66SF

**Coupling Gaskets:**

- Pre-lubricated Grade E-EPDM (Green Stripe)  
-30°F (-34°C) to +230°F (+110°C) Service Temperature Range  
For use with water service, diluted acids, alkali solutions, oil-free air and other chemical services. NOT FOR PETROLEUM, STEAM, or NATURAL GAS APPLICATIONS.
- Grade T-Nitrile (Orange Stripe)  
-20°F (-29°C) to +180°F (+82°C) Service Temperature Range  
For use with petroleum applications, vegetable & mineral oils, and air with oil vapors. NOT FOR USE IN HOT WATER, STEAM, or NATURAL GAS APPLICATIONS.
- Other: \_\_\_\_\_

**Nuts and Bolts:**

Zinc electroplated, heat treated, oval neck track head bolts conforming to ASTM 183 Grade 2 with a minimum tensile strength of 110,000psi; Heavy hex nuts made of carbon steel conforming to ASTM A-563 Grade A or Grade B, or J995 Grade 2.

SCI Track Bolts are 100% Magnetic Particle Inspected  
The SCI logo appears on all COOPLOK™ track bolts.

Project Information	
Project /Job:	System:
Date:	
Engineer/Architect:	
Contractor:	
Address:	
Notes:	



# 1000 Series Standard Weight Flexible Couplings

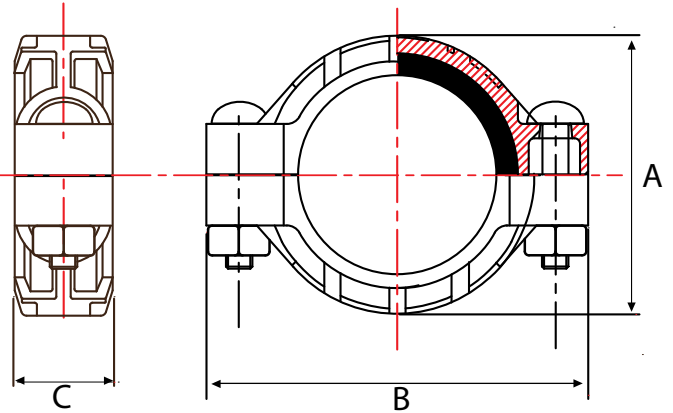

**Fig. 65SF & 66SF – Standard Weight Flexible Couplings**

Part Number		Pipe Size IN / mm	Pipe OD IN / mm	Max Pipe End Gap IN / mm	Max End Load LB / kg	Max Working Pressure PSI / bar	Dimensions			Bolt Size IN / mm	Weight LB / kg
Painted	Galv						A IN / mm	B IN / mm	C IN / mm		
65SF5010	66SF3010	1	1.315	1/8	1,358	1000	2.34	3.94	1.73	3/8" x 2	1.2
		25	33.7	3.2	616	68.9	59.5	100	44	M10 x 52	.5
65SF5012	66SF3012	1-1/4	1.660	1/8	2,164	1000	2.70	4.41	1.89	1/2" x 3-1/4	2.0
		32	42.4	3.2	981	68.9	68.5	112	48	M12 x 80	.9
65SF5014	66SF3014	1-1/2	1.900	1/8	2,835	1000	2.93	4.69	1.89	1/2" x 3-1/4	2.1
		40	48.3	3.2	1,286	68.9	74.5	119	48	M12 x 80	1
65SF5020	66SF3020	2	2.375	1/8	4,430	1000	3.48	5.20	1.61	1/2" x 3-1/4	2.6
		50	60.3	3.2	2,009	68.9	88.5	132	41	M12 x 80	1.2
65SF5024	66SF3024	2-1/2	2.875	1/8	6,492	1000	4.04	5.71	1.89	1/2" x 3-1/4	3.1
		65	73	3.2	2,944	68.9	102.5	145	48	M12 x 80	1.4
65SF5030	66SF3030	3	3.500	1/8	9,621	1000	4.63	6.50	1.89	1/2" x 3-1/4	3.7
		88.9	88.9	3.2	4,363	68.9	117.5	165	48	M12 x 80	1.7
65SF5040	66SF3040	4	4.500	1/4	15,904	1000	6.00	8.35	2.13	5/8" x 3-3/4	6.7
		100	114.3	6.4	7,213	68.9	152.4	212	54	M16 x 95	3
65SF5050	66SF3050	5	5.563	1/4	24,306	1000	7.07	10.04	2.13	3/4" x 4-1/2	10.6
		125	141.3	6.4	11,023	68.9	179.5	255	54	M19 x 110	4.8
65SF5060	66SF3060	6	6.625	1/4	34,472	1000	8.31	11.42	2.15	3/4" x 4-1/2	12
		150	168.3	6.4	15,633	68.9	211	290	54.5	M19 x 110	5.4
65SF5080B	66SF3080B	8	8.625	1/4	58,426	1000	10.35	13.62	2.48	7/8" x 5-1/4	20.8
		200	219.1	6.4	26,496	68.9	263	346	63	M23 x 130	9.4

**NOTES:**

- All bolts and gaskets identified by SCI logo.
- 100% Magnetic particle inspection of each bolt. Each bolt has a minimum tensile strength of 110,000 psi.
- Gaskets are pre-lubricated.
- Gasket Grade E EPDM (green stripe):
  - Temperature range: -30°F (-34°C) to +230°F (+110°C).
- Gasket Grade T Nitrile (orange stripe):
  - Temperature range: -20°F (-29°C) to +180°F (+82°C).

Torque Requirements for Bolts (ft./lbs)	
Coupling Size	Fig. 65SF & Fig. 66 SF
1"	30
1-1/4" - 1-1/2"	90
2" - 2-1/2"	90
3" - 4"	90
5" - 6"	200
8"	250

30 ft./lbs. = 40 N/M
50 ft./lbs. = 67 N/M
90 ft./lbs. = 121 N/M
150 ft./lbs. = 202 N/M

