



COOPLOK™ Grooved Submittal

**Fig. 65RC & 66RC
Reducing Coupling**

Figure 65RC & 66RC Reducing Couplings are designed to directly connect two different sizes of pipe; no additional fittings or couplings are required.



Material Specifications

Housing:

Ductile Iron Housings conform to ASTM A-536, Grade 65-45-12

Coating:

- Orange Paint (Rust inhibiting) - Standard Coating – Fig 65RC
- Hot Dipped Galvanized conforming to ASTM A-153 – Fig 66RC

Coupling Gaskets:

- Pre-lubricated Grade E-EPDM (Green Stripe)
-30°F (-34°C) to +230°F (+110°C) Service Temperature Range
For use with water service, diluted acids, alkali solutions, oil-free air and other chemical services. NOT FOR PETROLEUM, STEAM, or NATURAL GAS APPLICATIONS.
- Grade T-Nitrile (Orange Stripe)
-20°F (-29°C) to +180°F (+82°C) Service Temperature Range
For use with petroleum applications, vegetable & mineral oils, and air with oil vapors. NOT FOR USE IN HOT WATER, STEAM, or NATURAL GAS APPLICATIONS.
- Other: _____

Nuts and Bolts:

Zinc electroplated, heat treated, oval neck track head bolts conforming to ASTM 183 Grade 2 with a minimum tensile strength of 110,000psi; Heavy hex nuts made of carbon steel conforming to ASTM A-563 Grade A or Grade B, or J995 Grade 2.

SCI Track Bolts are 100% Magnetic Particle Inspected
The SCI logo appears on all COOPLOK™ track bolts.

Project Information	
Project /Job:	System:
Date:	
Engineer/Architect:	
Contractor:	
Address:	
Notes:	



500 Series Reducing Couplings

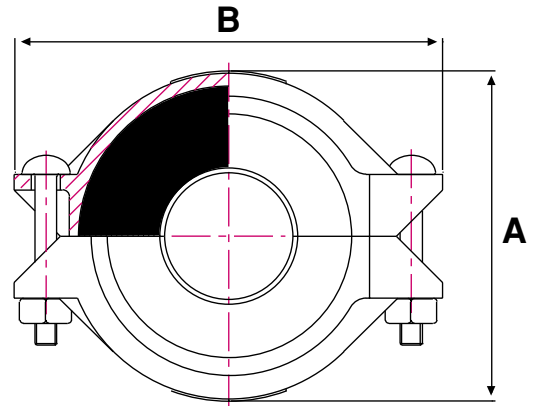
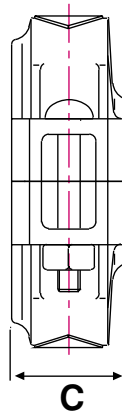

Fig. 65RC & 66RC – Reducing Couplings

Pipe Size IN / mm	Part Number		Max Pipe End Gap IN / mm	Max Working Pressure PSI / bar	Dimensions			Bolt Size IN / mm	Deflection Degrees	Weight LB / kg
	Painted	Galv			A IN / mm	B IN / mm	C IN / mm			
2 x 1-1/2 50 x 40	65RC3020014	66RC3020014	1/8 3.2	300 20.7	3.43 87.1	4.88 124.0	1.85 47.0	3/8 x 2-1/4 M10 x 57	2.0°	1.9 0.9
2-1/2 x 2 65 x 50	65RC3024020	66RC3024020	1/8 3.2	300 20.7	3.98 101.1	5.35 135.9	1.85 47.0	3/8 x 2-1/2 M10 x 64	1.5°	2.3 1.0
3 x 2 80 x 50	65RC3030020	66RC3030020	1/8 3.2	300 20.7	4.59 116.6	6.34 161.0	1.85 47.0	3/8 x 2-1/2 M10 x 64	1.8°	3.1 1.4
3 x 2-1/2 80 x 65	65RC3030024	66RC3030024	1/8 3.2	300 20.7	4.51 114.6	6.34 161.0	1.85 47.0	3/8 x 2-1/2 M10 x 64	1.8°	2.9 1.3
4 x 2 100 x 50	65RC3040020	66RC3040020	1/4 6.4	300 20.7	5.83 148.1	7.52 191.0	2.01 51.1	1/2 x 3 M12 x 76	1.2°	4.8 2.2
4 x 2-1/2 100 x 65	65RC3040024	66RC3040024	1/4 6.4	300 20.7	5.83 148.1	7.52 191.0	2.01 51.1	1/2 x 3 M12 x 76	1.2°	4.8 2.2
4 x 3 100 x 80	65RC3040030	66RC3040030	1/4 6.4	300 20.7	5.83 148.1	7.52 191.0	2.01 51.1	1/2 x 3 M12 x 76	1.2°	4.4 2.0
6 x 4 150 x 100	65RC3060040	66RC3060040	1/4 6.4	300 20.7	7.99 202.9	10.35 262.9	2.01 51.1	5/8 x 3-3/4 M16 x 95	0.9°	9 4.1
8 x 6 200 x 100	65RC3080060	66RC3080060	1/4 6.4	300 20.7	10.12 257.0	13.15 334.0	2.48 63.0	5/8 x 3-3/4 M19 x 108	0.8°	14.6 6.6

NOTES:

- All bolts and gaskets identified by SCI logo.
- 100% Magnetic particle inspection of each bolt. Each bolt has a minimum tensile strength of 110,000 psi.
- Gaskets are pre-lubricated.
- Gasket Grade E EPDM (green stripe):
 - Temperature range: -30°F (-34°C) to +230°F (+110°C).
- Gasket Grade T Nitrile (orange stripe) available:
 - Temperature range: -20°F (-29°C) to +180°F (+82°C).
- See Installation Instructions on Page 20.
- SMITH-COOPER Warranty (see page 19) only applies to assemblies made up using gaskets, housings, and bolts with the SCI logo.

Torque Requirements for Bolts
(ft./lbs)

Coupling Size	Fig. 65RC & Fig. 66RC	
1-1/4" - 1-1/2"	-	
2" - 2-1/2"	30	
3" - 4"	50	30 ft./lbs. = 40 N/M
5" - 6"	90	50 ft./lbs. = 67 N/M
8"	150	90 ft./lbs. = 121 N/M 150 ft./lbs. = 202 N/M

