



COOPLOK™ Grooved Submittal

**Fig. 65FH & 66FH
Hinged Flange Adapter**

Figure 65FH & 66FH Hinged Flange Adapters connect grooved pipe directly to any flat or raised face Class 125/150 flange.



Material Specifications

Housing:

Ductile Iron Housings conform to ASTM A-536, Grade 65-45-12

Coating:

- Orange Paint (Rust inhibiting) - Standard Coating – Fig 65FH
- Hot Dipped Galvanized conforming to ASTM A-153 – Fig 66FH

Coupling Gaskets:

- Pre-lubricated Grade E-EPDM (Green Stripe)
-30°F (-34°C) to +230°F (+110°C) Service Temperature Range
For use with water service, diluted acids, alkali solutions, oil-free air and other chemical services. NOT FOR PETROLEUM, STEAM, or NATURAL GAS APPLICATIONS.
- Grade T-Nitrile (Orange Stripe)
-20°F (-29°C) to +180°F (+82°C) Service Temperature Range
For use with petroleum applications, vegetable & mineral oils, and air with oil vapors. NOT FOR USE IN HOT WATER, STEAM, or NATURAL GAS APPLICATIONS.
- Other: _____

Latch Bolt & Nut:

Zinc electroplated, heat treated, oval neck track head bolts conforming to ASTM 183 Grade 2 with a minimum tensile strength of 110,000psi; Heavy hex nuts made of carbon steel conforming to ASTM A-563 Grade A or Grade B, or J995 Grade 2.

SCI Track Bolts are 100% Magnetic Particle Inspected
The SCI logo appears on all COOPLOK™ track bolts.

Project Information	
Project /Job:	System:
Date:	
Engineer/Architect:	
Contractor:	
Address:	
Notes:	



500 Series Hinged Flange Adapter

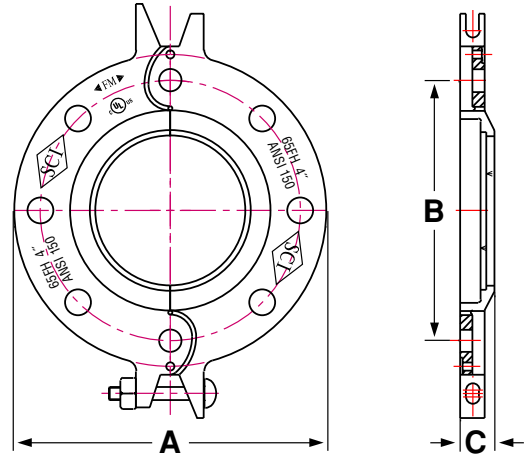

Fig. 65FH & 66FH – Hinged Flange Adapter

Pipe Size IN / mm	Part Number		Pipe OD IN / mm	Max Working Pressure PSI / bar	Dimensions			Flange Bolt Size IN / mm	Number of Flange Bolts	Weight LB / kg
	Painted	Galv			A IN / mm	B IN / mm	C IN / mm			
2 50	65FH3020	66FH3020	2.375 60.3	300 20.7	6.00 152.4	4.75 120.7	0.75 19.1	5/8 x 3 M16 x 76	4	3.6 1.6
2-1/2 65	65FH3024	66FH3024	2.875 73.0	300 20.7	7.00 177.8	5.50 139.7	0.88 22.4	5/8 x 3 M16 x 76	4	3.6 1.6
3 80	65FH3030	66FH3030	3.500 88.9	300 20.7	7.50 190.5	6.00 152.4	0.94 23.9	5/8 x 3 M16 x 76	4	4.8 2.2
4 100	65FH3040	66FH3040	4.500 114.3	300 20.7	9.00 228.6	7.50 190.5	0.94 23.9	5/8 x 3 M16 x 76	8	6.6 3.0
6 150	65FH3060	66FH3060	6.625 168.3	300 20.7	11.00 279.4	9.50 241.3	1.00 25.4	3/4 x 3-1/2 M19 x 89	8	8.4 3.8
8 200	65FH3080	66FH3080	8.625 219.1	300 20.7	13.50 342.9	11.75 298.5	1.12 28.4	3/4 x 3-1/2 M19 x 89	8	14.3 6.4

NOTES:

1. Latch bolts and gaskets identified by SCI logo.
2. 100% Magnetic particle inspection of each latch bolt; minimum tensile strength of 110,000 psi.
3. Gaskets are pre-lubricated.
4. Gasket Grade E EPDM (green stripe):
 - Temperature range: -30°F (-34°C) to +230°F (+110°C).
5. Gasket Grade T Nitrile (orange stripe):
 - Temperature range: -20°F (-29°C) to +180°F (+82°C).
6. Matches class 125/150 flange dimensions.

