



COOPLOK™ Grooved Submittal

Adapter Elbows

Fig. 65AE & 66AE Adapter Elbows
(Grooved x Threaded)

COOPLOK™ Adapter Elbows are typically used in fire sprinkler systems at the end of a branch line where the last fire sprinkler is installed. Also used for “sprig-ups”, “drops”, drains, vents, and gauges.



Material Specifications

Castings:

Ductile Iron Body conforms to ASTM A-536, Grade 65-45-12

Coating:

- Orange Paint (rust inhibiting) - Standard Coating
- Hot Dipped Galvanized conforming to ASTM A-153
- Other _____

Project Information	
Project /Job:	System:
Date:	
Engineer/Architect:	
Contractor:	
Address:	
Notes:	



500 Series Adapter Elbow, Grooved x Threaded

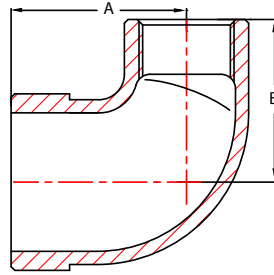

Fig. 65AE & 66AE – Adapter Elbow, Grooved x Threaded

Size Run x Branch IN / mm	Part Number		Max Working Pressure PSI / bar	Dimensions		Weight LB / kg
	Painted	Galv		A IN / mm	B IN / mm	
1-1/4 x 1/2 32 x 15	65AE3012004	66AE3012004	300 20.7	1.88 48	1.75 48	0.6 0.3
1-1/4 x 3/4 32 x 20	65AE3012006	66AE3012006	300 20.7	1.88 48	1.75 48	0.6 0.3
1-1/4 x 1 32 x 25	65AE3012010	66AE3012010	300 20.7	2.02 51.3	2.00 50.8	0.8 0.4
1-1/2 x 1/2 40 x 15	65AE3014004	66AE3014004	300 20.7	1.88 48	1.75 48	0.6 0.3
1-1/2 x 3/4 40 x 20	65AE3014006	66AE3014006	300 20.7	1.88 48	1.75 48	0.6 0.3
1-1/2 x 1 40 x 25	65AE3014010	66AE3014010	300 20.7	2.02 51.3	2.00 50.8	0.8 0.4
2 x 1/2 50 x 15	65AE3020004	66AE3020004	300 20.7	1.88 48	1.75 48	0.8 0.4
2 x 3/4 50 x 20	65AE3020006	66AE3020006	300 20.7	1.88 48	1.75 48	0.8 0.4
2 x 1 50 x 25	65AE3020010	66AE3020010	300 20.7	2.02 51.3	2.00 50.8	1.0 0.5
2-1/2 x 1/2 65 x 15	65AE3024004	66AE3024004	300 20.7	1.88 48	1.97 50	1.0 0.5
2-1/2 x 3/4 65 x 20	65AE3024006	66AE3024006	300 20.7	1.88 48	1.97 50	1.0 0.5
2-1/2 x 1 65 x 25	65AE3024010	66AE3024010	300 20.7	2.02 51.3	2.00 50.8	1.2 0.6